







LEGENDE :

-  borne pierre existante
-  borne plastique existante
-  borne nouvelle
-  limite certaine définie dans un acte foncier antérieur ou issue du plan de remembrement
-  future nouvelle limite
-  application cadastrale (non définie)



LE GEOMETRE-EXPERT :

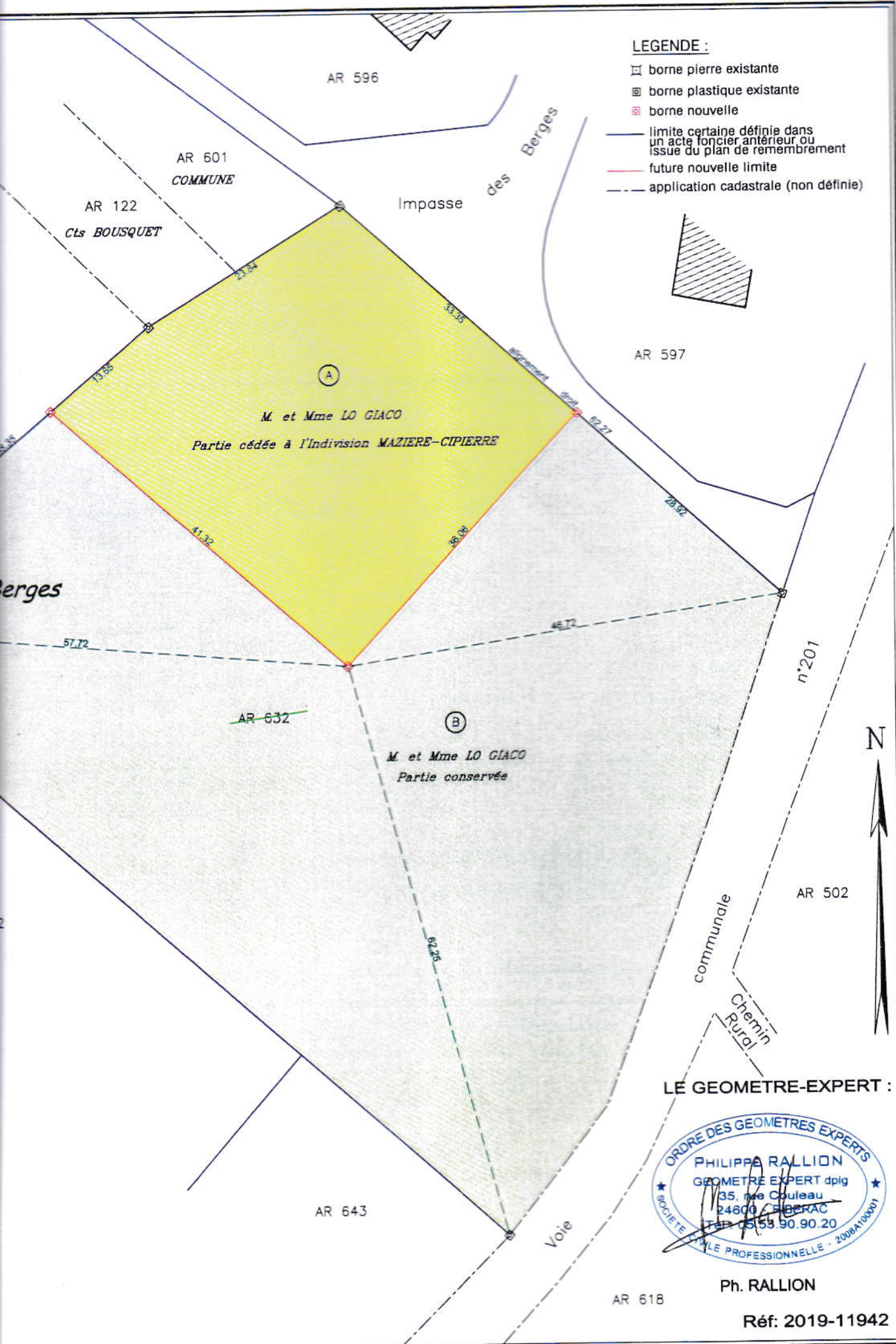

Ph. RALLION

Réf: 2019-11942